

TYÖNTÖSALPA CANE BOLT

Mallit 150 - 300 mm lukittavissa riippulukolla.
Models 150 - 300 mm can be secured with a padlock.

Materiaali / Material:
FE/ZN
Galvanized steel

L = 110 mm



L = 80 mm

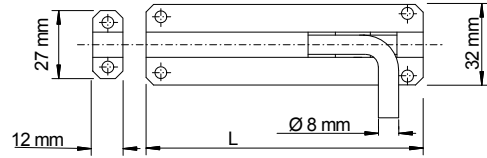

Runkoaine / Plate material:
1 mm

L = 150 - 300 mm

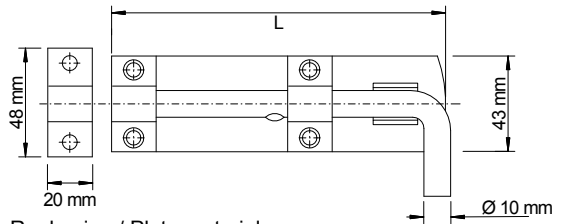

Runkoaine / Plate material:
2 mm

Vedintyöntösarpa L = 150 mm
With pull handle L = 150 mm

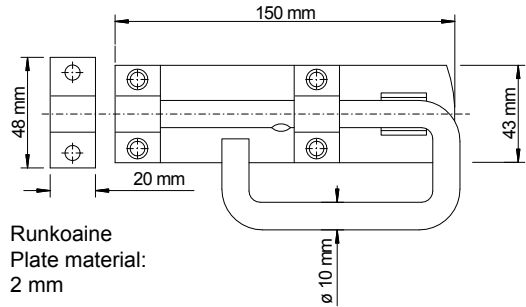
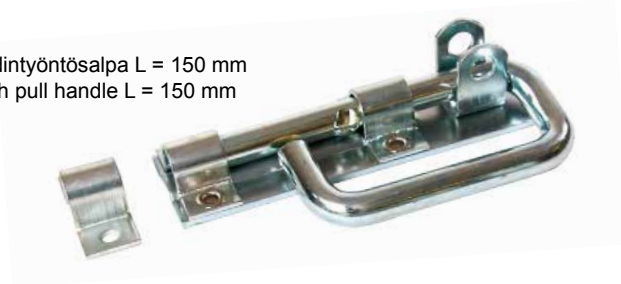

Runkoaine
Plate material:
2 mm

Jousitoiminen työntösarpa
Spring operated can bolt

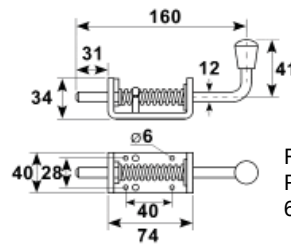

Runkoaine
Plate material:
6 mm

Malli Model L mm	Tuote Product	Pakkaus Packing
80	1501001110 1501001112 (IP / SSP)	20 kpl/pc (IP / SSP)
110	1502001110 1502001112 (IP / SSP)	20 kpl/pc (IP / SSP)
150	1503101110 1503101112 (IP / SSP)	10 kpl/pc (IP / SSP)
160	1503201110 1503201112 (IP / SSP)	10 kpl/pc (IP / SSP)

Malli Model L mm	Tuote Product	Pakkaus Packing
250	1503301110 1503301112 (IP / SSP)	10 kpl/pc (IP / SSP)
300	1503401110 1503401112 (IP / SSP)	10 kpl/pc (IP / SSP)
150 Vedintyöntösarpa 150 With pull handle	1508001110 1508001112	10 kpl/pc 5 (IP / SSP)
Jousitoiminen Spring operated	1505601110 1505601112 (IP / SSP)	kpl (IP / SSP)

